

The information in this document is subject to change without notice and should not be construed as a commitment by ABB. ABB assumes no responsibility for any errors that may appear in this document.

Except as may be expressly stated anywhere in this document, nothing herein shall be construed as any kind of guarantee or warranty by ABB for losses, damages to persons or property, fitness for a specific purpose or the like.

In no event shall ABB be liable for incidental or consequential damages arising from use of this document.

This document and parts thereof must not be reproduced or copied without ABB's written permission, and contents thereof must not be imparted to a third party nor be used for any unauthorized purpose. Contravention will be prosecuted.

Additional copies of this document may be obtained from ABB at its then current charge.

© Copyright 2023 ABB ALL right reserved.

ABB Engineering (Shanghai) Ltd  
No.4528, Kangxin Highway,Kangqiao Town  
Pudong New District, Shanghai, 201319  
P.R.China

Latest revision:  
ECO 500000126325  
Initiate RB1510ID circuit diagram based on 3HAC039498-007 Rev.03

Prepared by, date: CNHOCH3, 230412

Approved by, date: Marcus Wadstein, 230413



Lab/Office:  
DMRO RA/RDP

IRB1510ID Manipulator

Copyright Page

Status:  
Approved

Plant: = IRB1510ID  
Location: + CONT  
Sublocation: +

Document no.  
3HAC087368-003

Rev. Ind  
00

Page 1  
Next 2  
Total 15

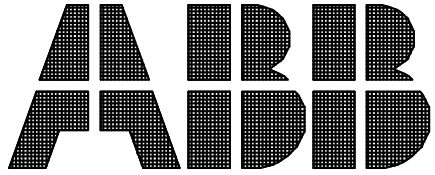

Description : IRB1510ID Manipulator  
 Drawing number : 3HAC087368-003  
 Drawing version : 00  
 Date :

Customer :  
 Year of construction :  
 :  
 :  
 :  
 :  
 :  
 :  
 :

Drawn by :  
 Number of pages : 15  
 :  
 :  
 :  
 :

Latest revision:  
 ECO 500000126325  
 Initiate RB1510ID circuit diagram based on 3HAC039498-007 Rev.03

Prepared by, date: CNHOCH3, 230412 | Approved by, date: Marcus Wadstein, 230413



Lab/Office:  
 DMRO RA/RDP

IRB1510ID Manipulator

Title page

|                                |                                     |                              |
|--------------------------------|-------------------------------------|------------------------------|
| Status:<br>Approved            | Plant:<br>Location:<br>Sublocation: | = IRB1510ID<br>+ CONT<br>+   |
| Document no.<br>3HAC087368-003 | Rev. Ind<br>00                      | Page 2<br>Next 3<br>Total 15 |

We reserve all rights in this document and in the information contained therein. Reproduction, use or disclosure to third parties without express authority is strictly forbidden. © Copyright 2013 ABB



# Revision information

2023-04-12 Rev.00  
 ECO 500000126325 : Initiate RB1510ID circuit diagram.

We reserve all rights in this document and in the information contained therein. Reproduction, use or disclosure to third parties without express authority is strictly prohibited. © Copyright 2023 ABB

|  |                                    |  |
|--|------------------------------------|--|
| Latest revision:<br>ECO 500000126325<br>Initiate RB1510ID circuit diagram based on 3HAC039498-007 Rev.03 | Prepared by, date: CNHOCH3, 230412 | Approved by, date: Marcus Wadstein, 230413 |
|--|------------------------------------|--|



|                       |
|-----------------------|
| IRB1510ID Manipulator |
| Revision information  |

|                                       |  |                                     |
|---------------------------------------|--|-------------------------------------|
| Status:<br><b>Approved</b>            | Plant:<br>Location: + CONT<br>Sublocation: + | = IRB1510ID                         |
| Document no.<br><b>3HAC087368-003</b> | Rev. Ind<br><b>00</b>                        | Page 4<br>Next +MANIP/5<br>Total 15 |

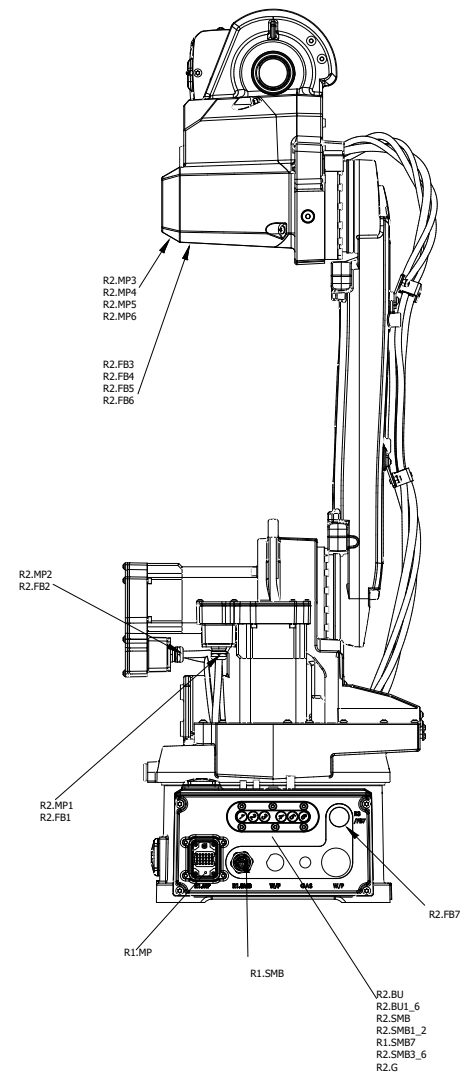
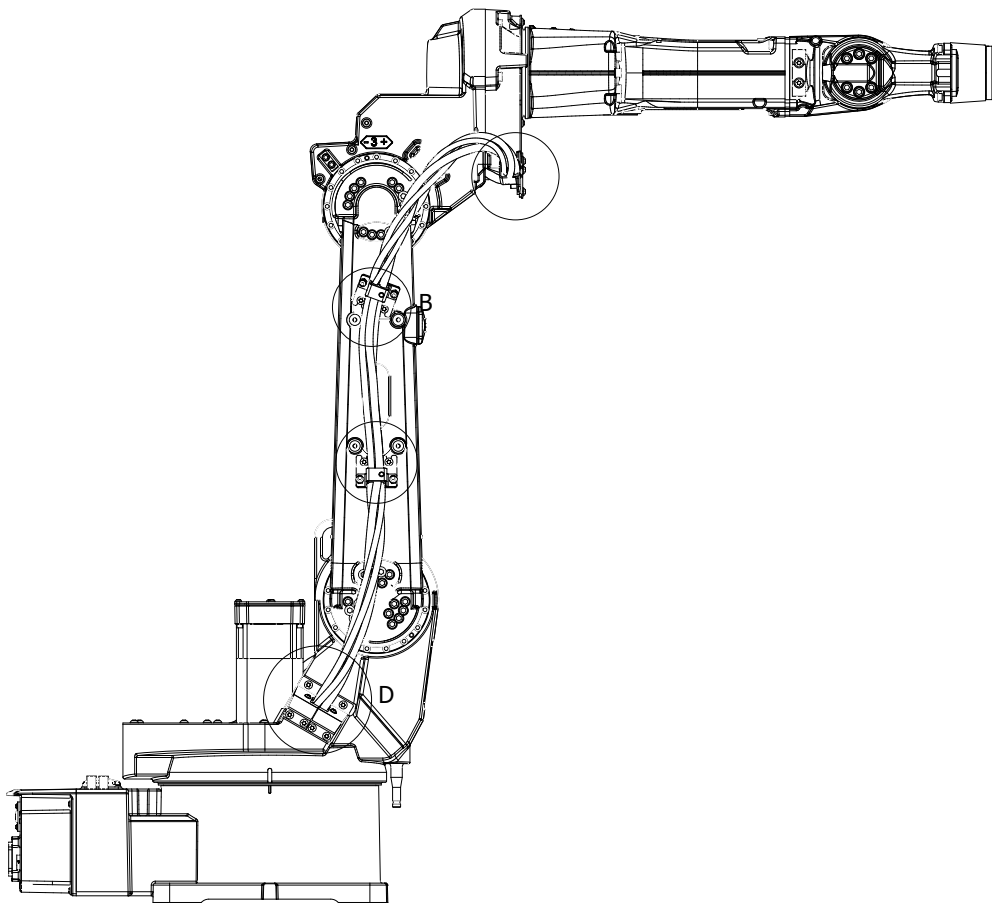

We reserve all rights in this document and in the information contained therein. Reproduction, use or disclosure to third parties without express authority is strictly forbidden. © Copyright 2013 ABB

Latest revision:  
 ECO 500000126325  
 Initiate RB1510ID circuit diagram based on 3HAC039498-007 Rev.03

Prepared by, date: CNHOCE3, 230412 | Approved by, date: Marcus Wadstein, 230413



Lab/Office:  
DMRO RA/RDP

IRB1510ID Manipulator  
 Manipulator Connector Layout

Status: Approved  
 Document no. 3HAC087368-003

Plant: = IRB1510ID  
 Location: + MANIP  
 Sublocation: +

|          |          |
|----------|----------|
| Rev. Ind | Page 5   |
| 00       | Next 6   |
|          | Total 15 |

We reserve all rights in this document and in the information contained therein. Reproduction, use or disclosure to third parties without express authority is strictly forbidden. © Copyright 2012 ABB

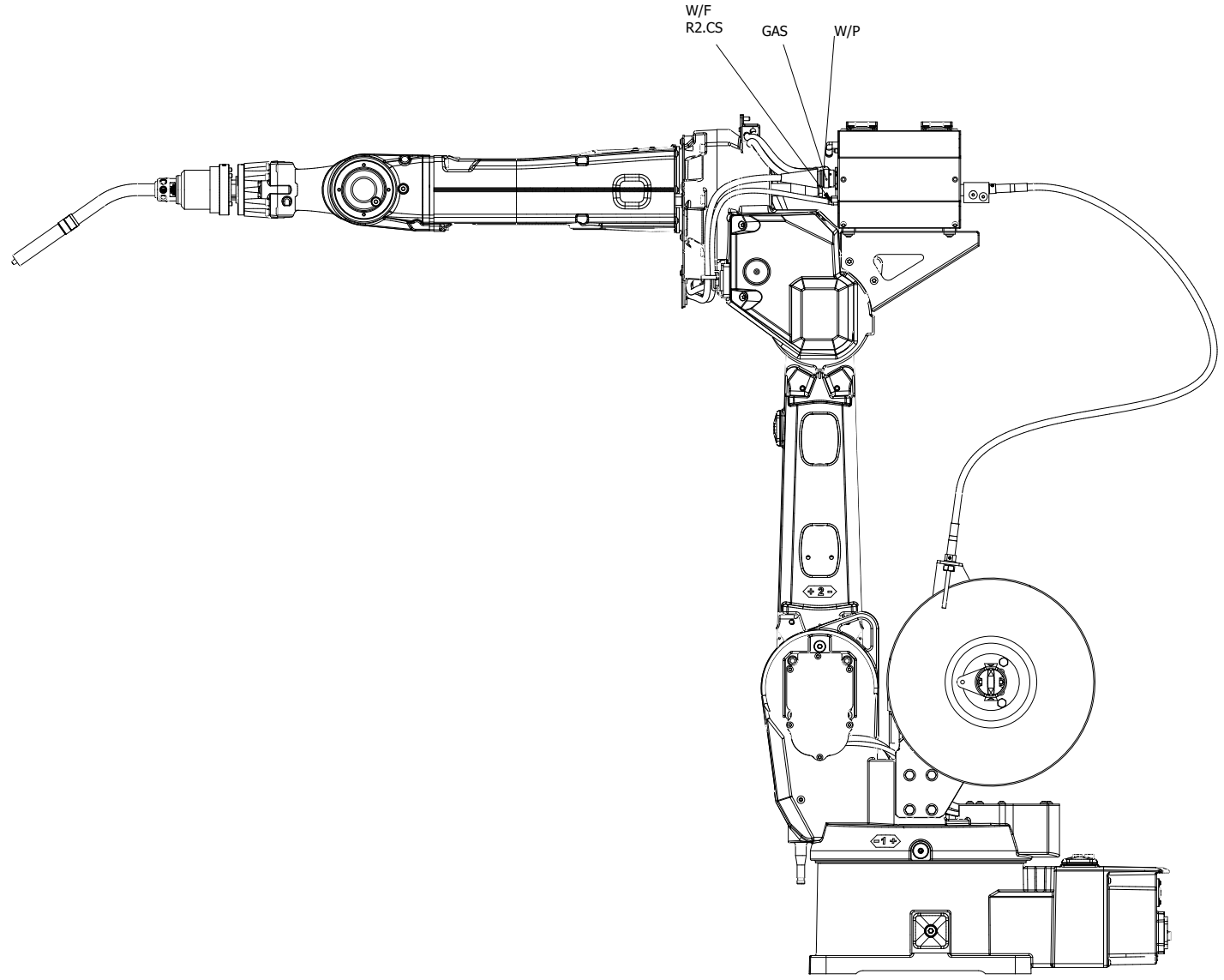
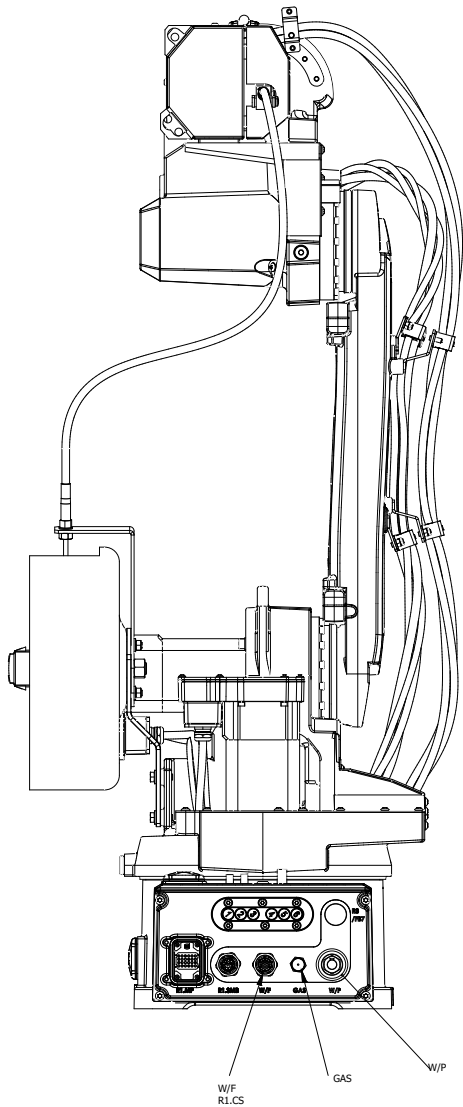

Latest revision:  
 ECO 500000126325  
 Initiate RB1510ID circuit diagram based on 3HAC039498-007 Rev.03

Prepared by, date: CNHOCE3, 230412

Approved by, date: Marcus Wadstein, 230413



Lab/Office:  
DMRO RA/RDP

IRB1510ID Manipulator

Manipulator Connector Layout  
(Arc Welding Option)

Status:  
Approved

Document no.  
3HAC087368-003

Plant: = IRB1510ID  
 Location: + MANIP  
 Sublocation: +

|          |            |
|----------|------------|
| Rev. Ind | Page 6     |
| 00       | Next +BU/7 |
|          | Total 15   |

We reserve all rights in this document and in the information contained therein. Reproduction, use or disclosure to third parties without express authority is strictly forbidden. © Copyright 2012 ABB

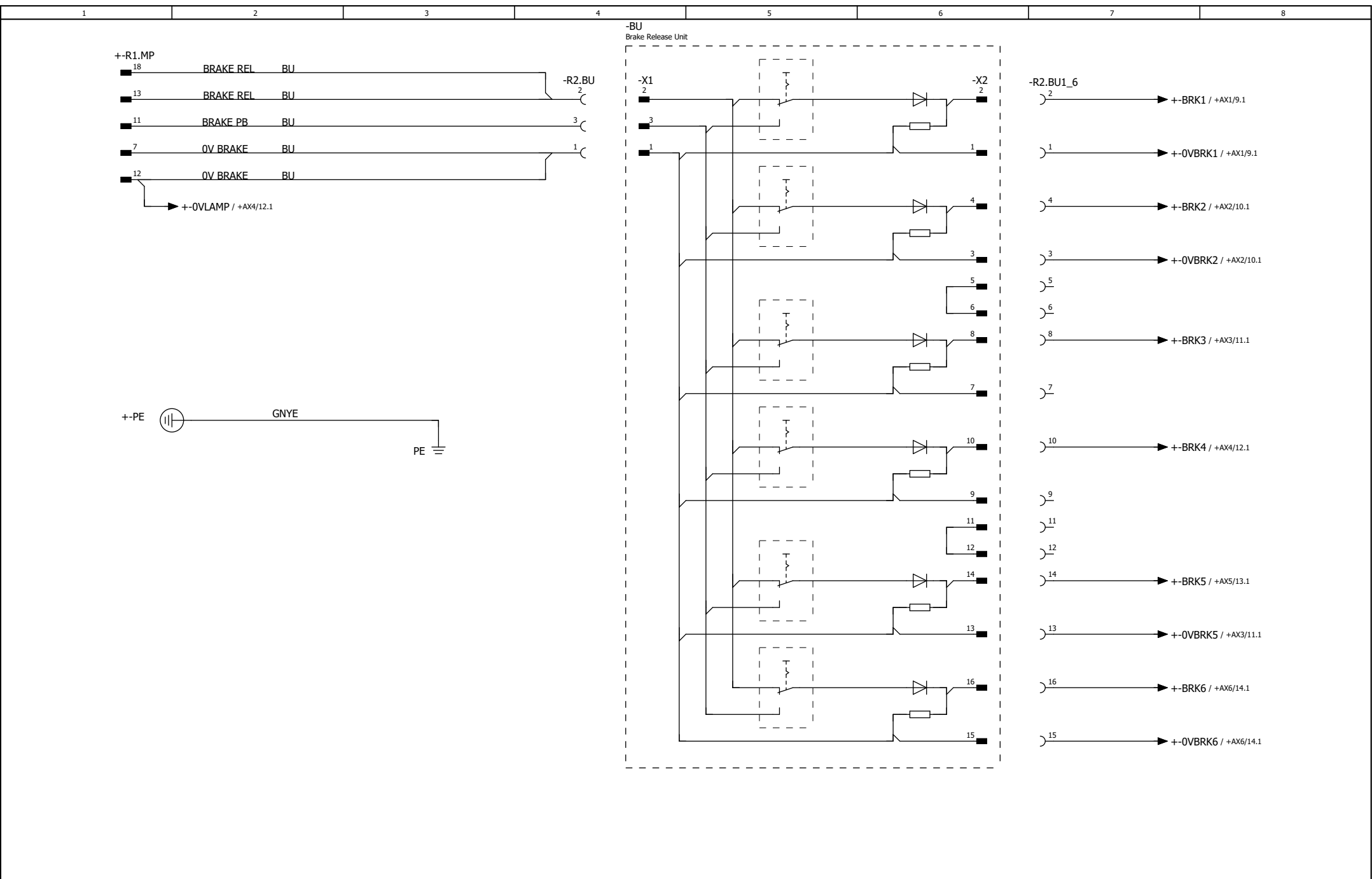

Latest revision:  
ECO 500000126325  
Initiate RB1510ID circuit diagram based on 3HAC039498-007 Rev.03

Prepared by, date: CNHOCH3, 230412 | Approved by, date: Marcus Wadstein, 230413

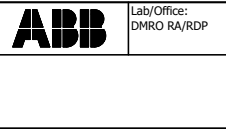

IRB1510ID Manipulator  
Brake Release Unit - BU

|                                |                                     |                                   |
|--------------------------------|-------------------------------------|-----------------------------------|
| Status:<br>Approved            | Plant:<br>Location:<br>Sublocation: | = IRB1510ID<br>+ BU<br>+          |
| Document no.<br>3HAC087368-003 | Rev. Ind<br>00                      | Page 7<br>Next +SMB/8<br>Total 15 |





We reserve all rights in this document and in the information contained therein. Reproduction, use or disclosure to third parties without express authority is strictly forbidden. © Copyright 2013 ABB

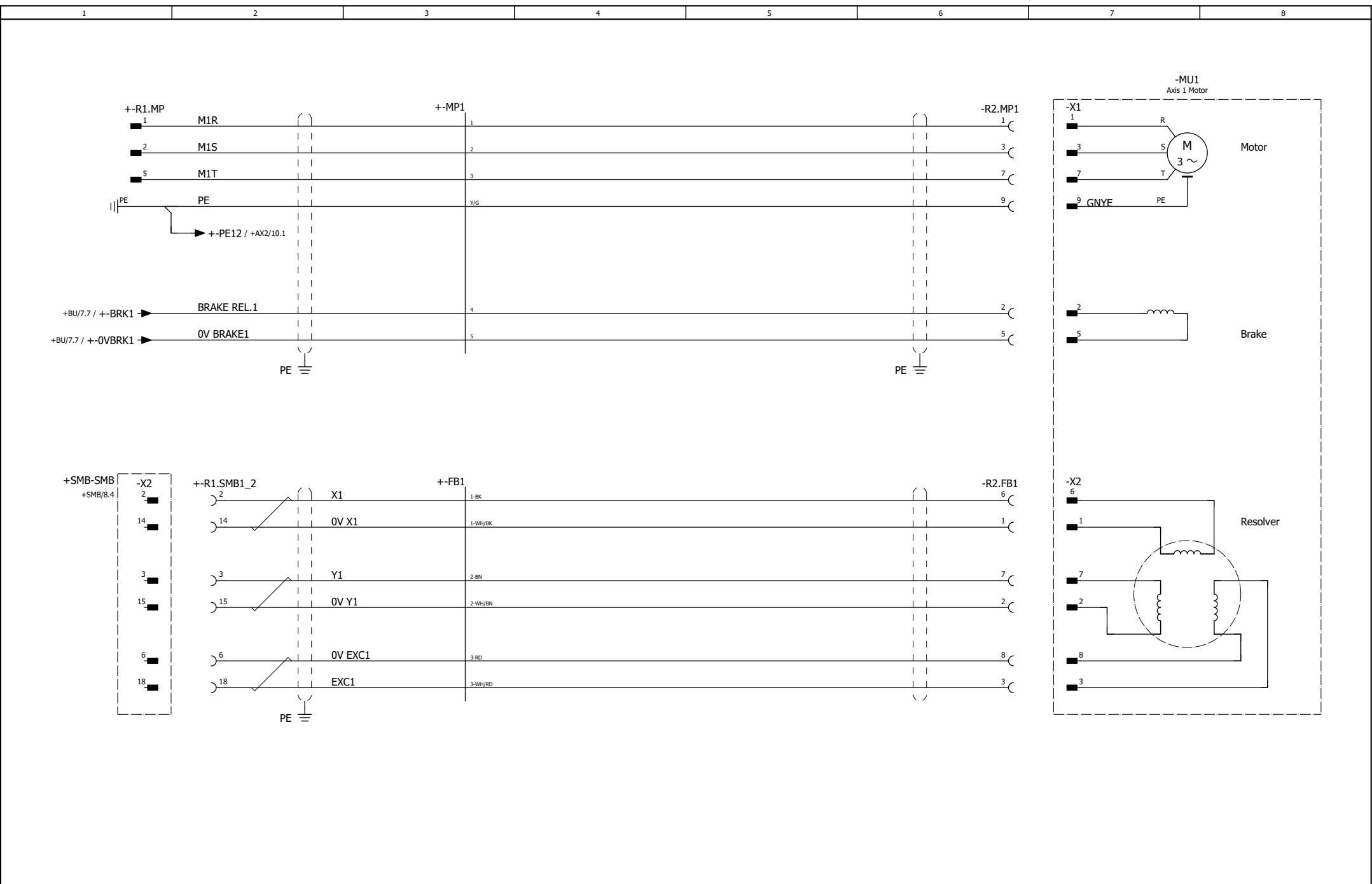

Latest revision:  
ECO 500000126325  
Initiate RB1510ID circuit diagram based on 3HAC039498-007 Rev.03

Prepared by, date: CNHOCH3, 230412 | Approved by, date: Marcus Wadstein, 230413

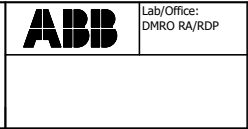

IRB1510ID Manipulator  
Axis 1 Motor Layout

|                                |                                     |                                    |
|--------------------------------|-------------------------------------|------------------------------------|
| Status:<br>Approved            | Plant:<br>Location:<br>Sublocation: | = IRB1510ID<br>+ AX1<br>+          |
| Document no.<br>3HAC087368-003 | Rev. Ind<br>00                      | Page 9<br>Next +AX2/10<br>Total 15 |

We reserve all rights in this document and in the information contained therein. Reproduction, use or disclosure to third parties without express authority is strictly forbidden. © Copyright 2012 ABB

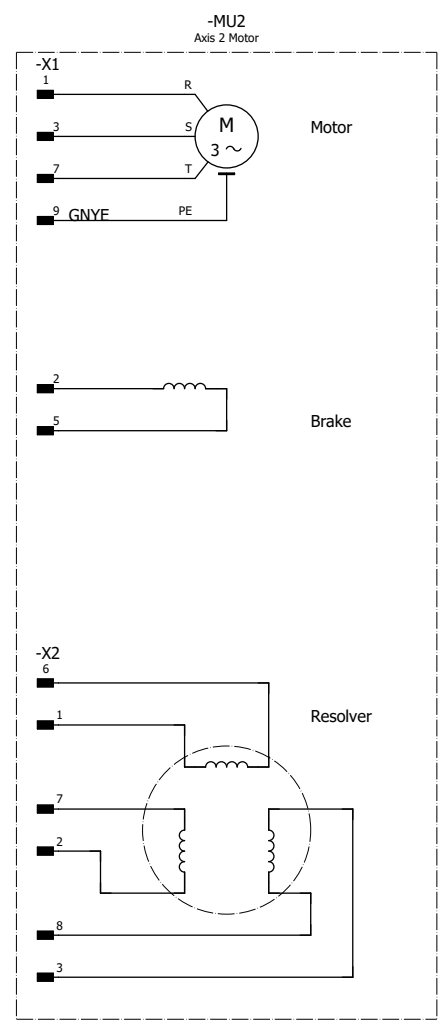
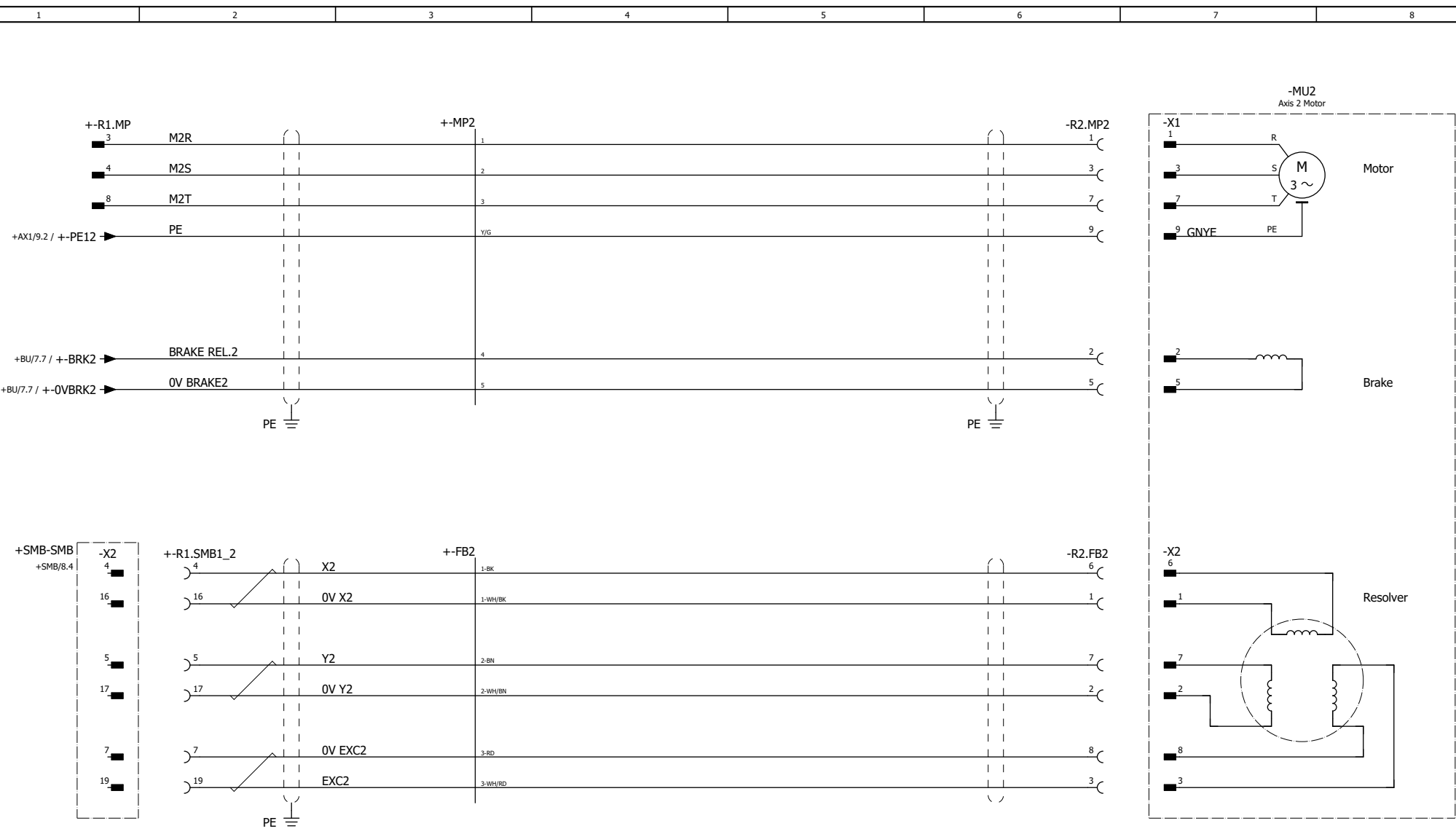

Latest revision:  
ECO 500000126325  
Initiate RB1510ID circuit diagram based on 3HAC039498-007 Rev.03

Prepared by, date: CNHOCH3, 230412 | Approved by, date: Marcus Wadstein, 230413



IRB1510ID Manipulator  
Axis 2 Motor Layout

|                                |                                     |                                     |
|--------------------------------|-------------------------------------|-------------------------------------|
| Status:<br>Approved            | Plant:<br>Location:<br>Sublocation: | = IRB1510ID<br>+ AX2<br>+           |
| Document no.<br>3HAC087368-003 | Rev. Ind<br>00                      | Page 10<br>Next +AX3/11<br>Total 15 |

We reserve all rights in this document and in the information contained therein. Reproduction, use or disclosure to third parties without express authority is strictly forbidden. © Copyright 2012 ABB

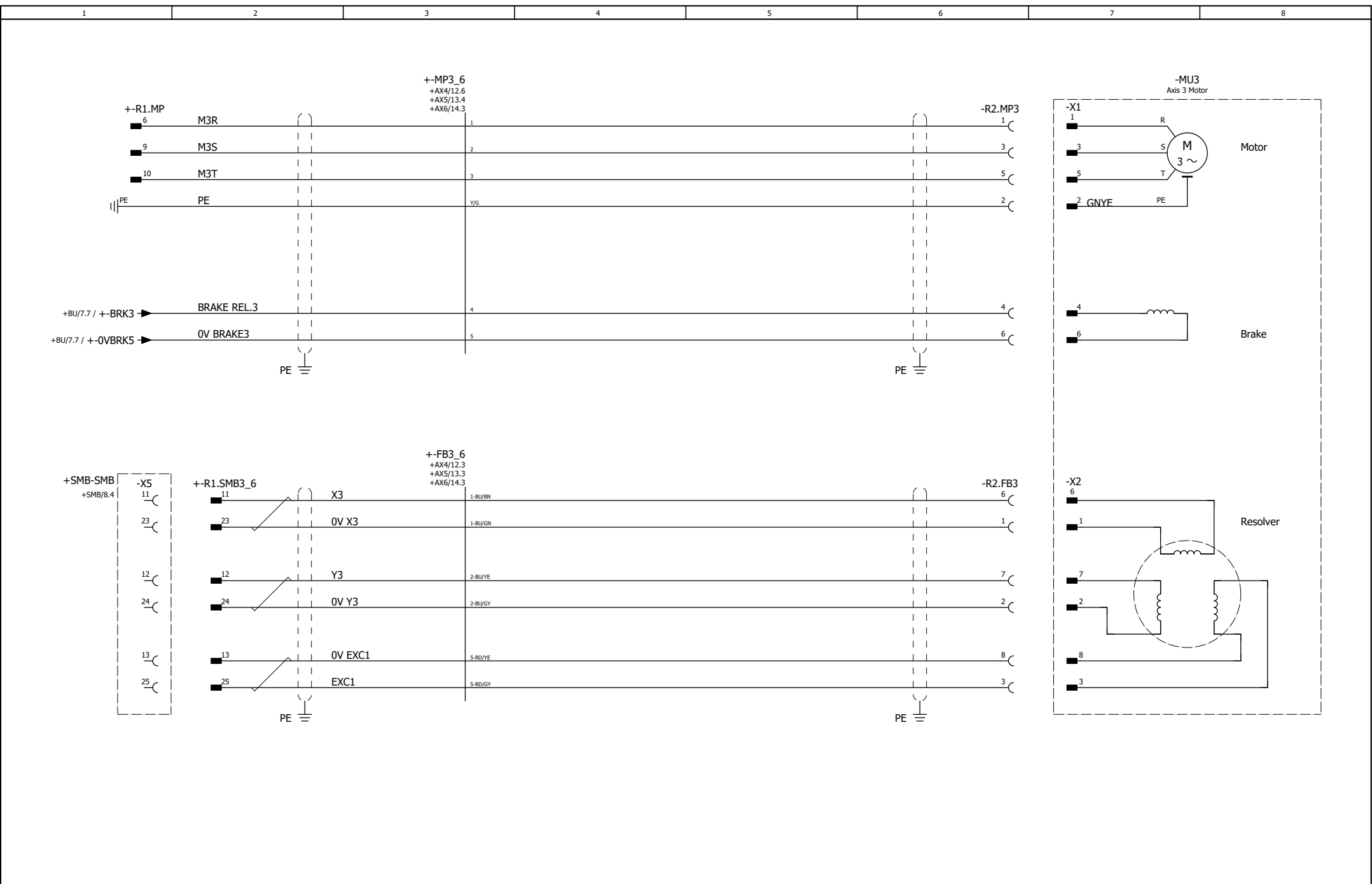

Latest revision:  
ECO 500000126325  
Initiate RB1510ID circuit diagram based on 3HAC039498-007 Rev.03

Prepared by, date: CNHOCH3, 230412 | Approved by, date: Marcus Wadstein, 230413



IRB1510ID Manipulator  
Axis 3 Motor Layout

|                                |                                     |                                     |
|--------------------------------|-------------------------------------|-------------------------------------|
| Status:<br>Approved            | Plant:<br>Location:<br>Sublocation: | = IRB1510ID<br>+ AX3<br>+           |
| Document no.<br>3HAC087368-003 | Rev. Ind<br>00                      | Page 11<br>Next +AX4/12<br>Total 15 |

We reserve all rights in this document and in the information contained therein. Reproduction, use or disclosure to third parties without express authority is strictly forbidden. © Copyright 2012 ABB

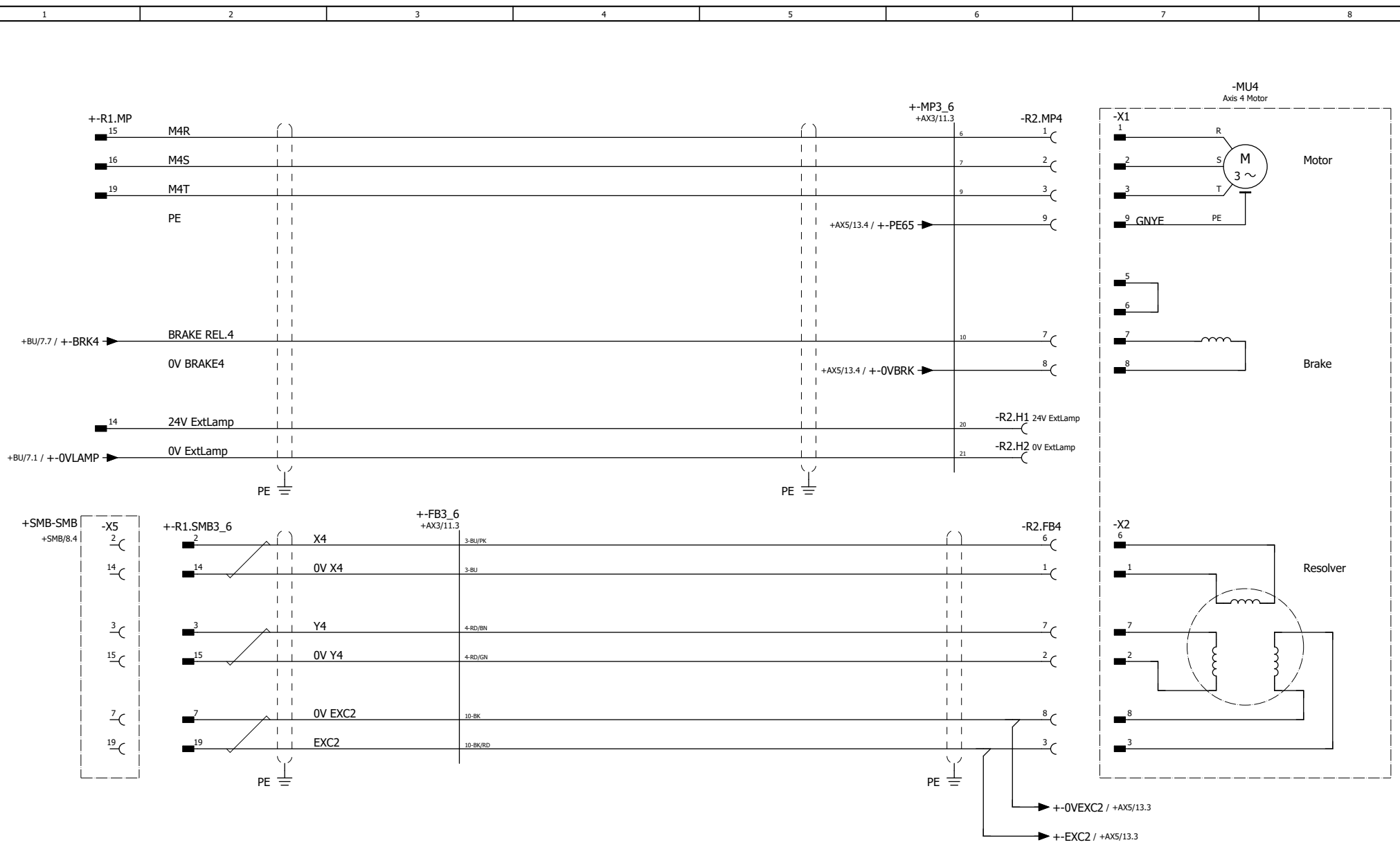

Latest revision:  
ECO 500000126325  
Initiate RB1510ID circuit diagram based on 3HAC039498-007 Rev.03

Prepared by, date: CNHOCH3, 230412 | Approved by, date: Marcus Wadstein, 230413



Lab/Office:  
DMRO RA/RDP

IRB1510ID Manipulator  
Axis 4 Motor Layout

Status:  
Approved

Document no.  
3HAC087368-003

Plant: = IRB1510ID  
Location: + AX4  
Sublocation: +

|          |              |
|----------|--------------|
| Rev. Ind | Page 12      |
| 00       | Next +AX5/13 |
|          | Total 15     |

We reserve all rights in this document and in the information contained therein. Reproduction, use or disclosure to third parties without express authority is strictly forbidden. © Copyright 2012 ABB

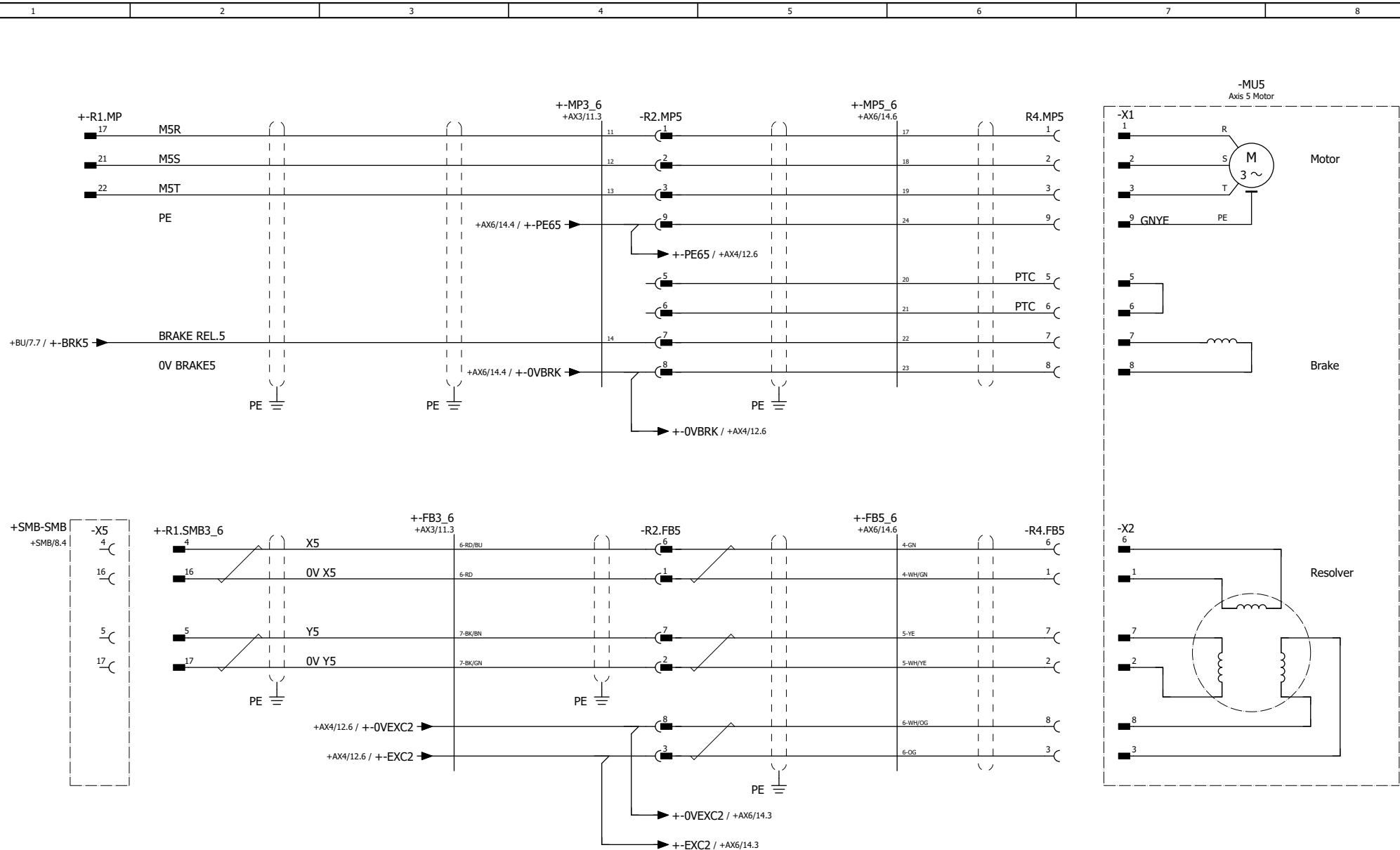

Latest revision:  
 ECO 500000126325  
 Initiate RB1510ID circuit diagram based on 3HAC039498-007 Rev.03

Prepared by, date: CNHOCH3, 230412 | Approved by, date: Marcus Wadstein, 230413



IRB1510ID Manipulator  
 Axis 5 Motor Layout

|                                |                                     |                                     |
|--------------------------------|-------------------------------------|-------------------------------------|
| Status:<br>Approved            | Plant:<br>Location:<br>Sublocation: | = IRB1510ID<br>+ AX5<br>+           |
| Document no.<br>3HAC087368-003 | Rev. Ind<br>00                      | Page 13<br>Next +AX6/14<br>Total 15 |

We reserve all rights in this document and in the information contained therein. Reproduction, use or disclosure to third parties without express authority is strictly forbidden. © Copyright 2013 ABB

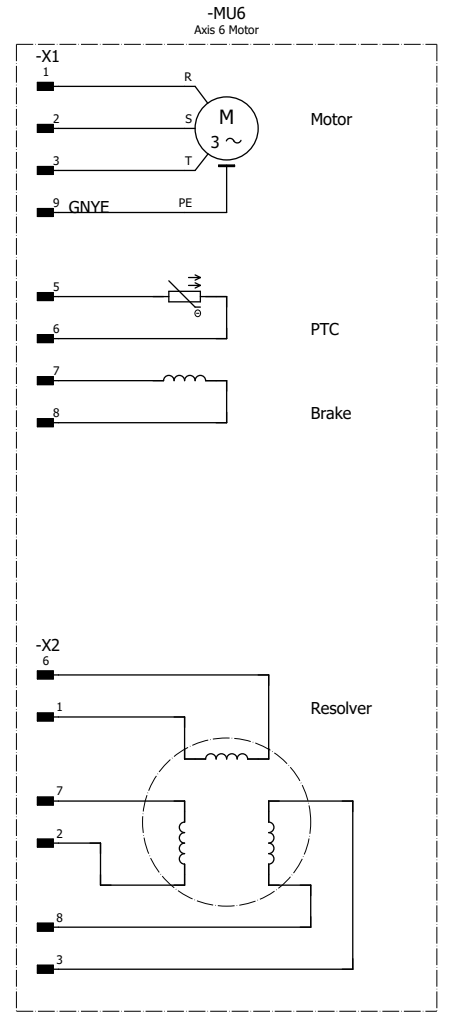
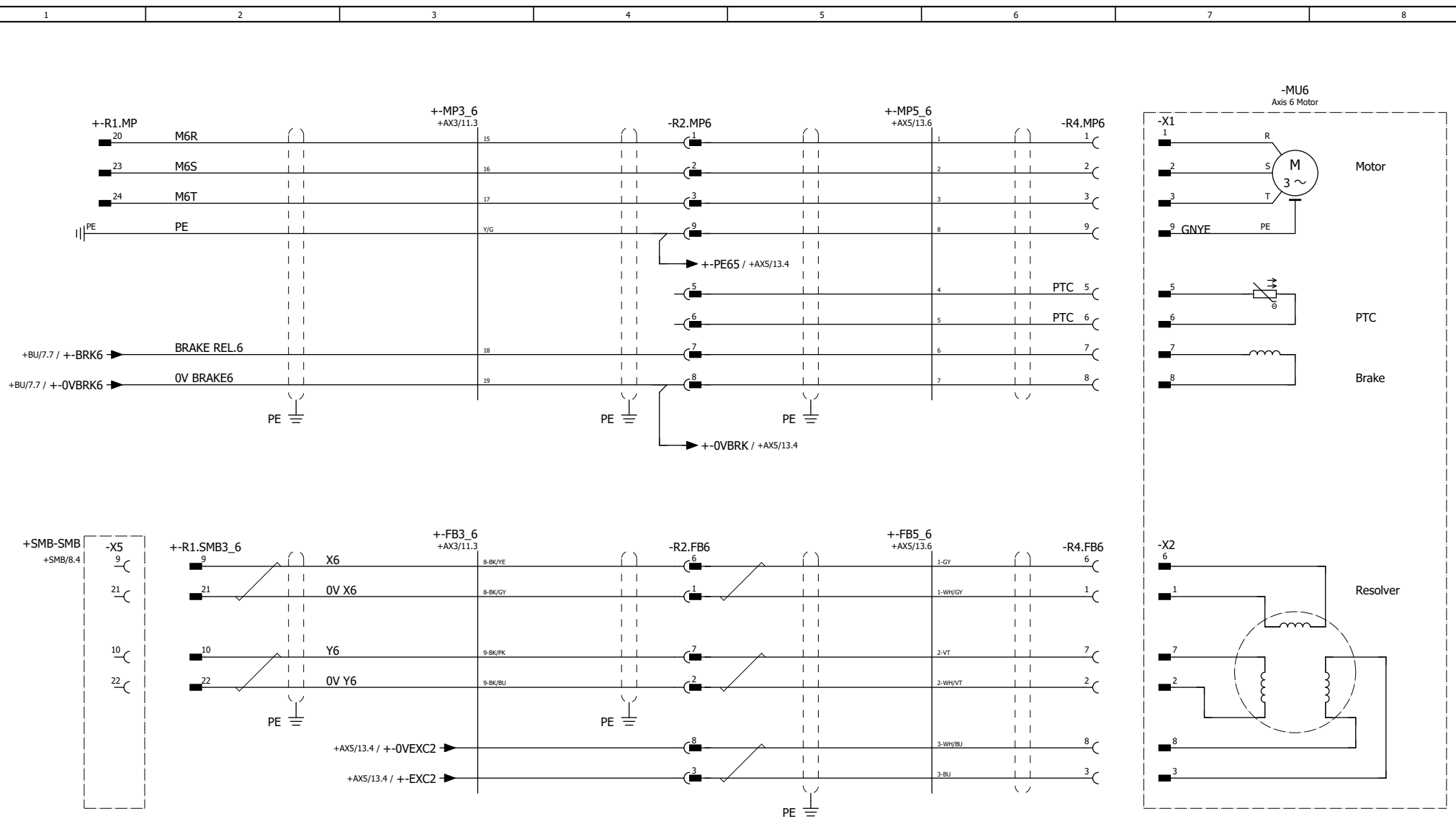

Latest revision:  
ECO 500000126325  
Initiate RB1510ID circuit diagram based on 3HAC039498-007 Rev.03

Prepared by, date: CNHOCH3, 230412 | Approved by, date: Marcus Wadstein, 230413



Lab/Office:  
DMRO RA/RDP

IRB1510ID Manipulator  
Axis 6 Motor Layout

Status:  
Approved

Plant: = IRB1510ID  
Location: + AX6  
Sublocation: +

Document no.  
3HAC087368-003

|          |             |
|----------|-------------|
| Rev. Ind | Page 14     |
| 00       | Next +CC/15 |
|          | Total 15    |

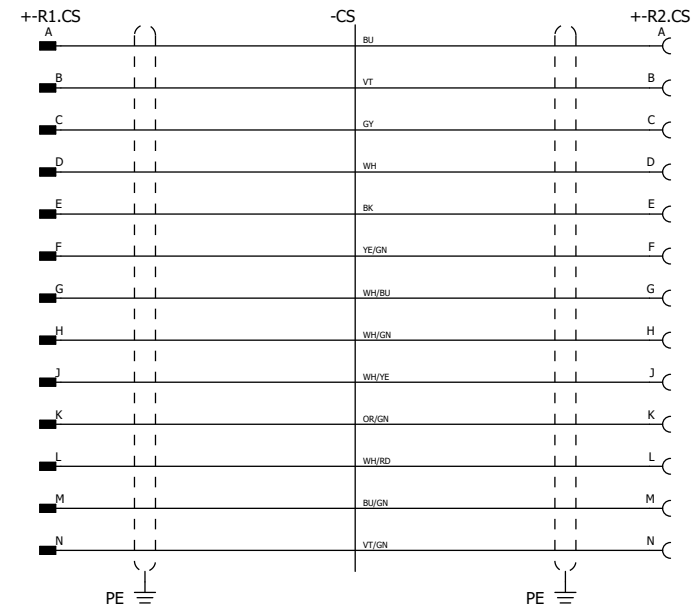

CUSTOMER CONNECTION  
SIGNAL (OPTION)

Latest revision:  
ECO 500000126325  
Initiate RB1510ID circuit diagram based on 3HAC039498-007 Rev.03

Prepared by, date: CNHOCH3, 230412 | Approved by, date: Marcus Wadstein, 230413



Lab/Office:  
DMRO RA/RDP

IRB1510ID Manipulator  
Customer Connections

Status: Approved  
Document no. 3HAC087368-003

Plant: = IRB1510ID  
Location: + CC  
Sublocation: +

Rev. Ind 00  
Page 15  
Next  
Total 15

We reserve all rights in this document and in the information contained therein. Reproduction, use or disclosure to third parties without express authority is strictly forbidden. © Copyright 2013 ABB